

FINISH KEY

COORDINATE WALL FINISHES WITH DECOR DRAWINGS.

- DECOR SALES AREA WALL FINISH AND DECOR, SEE INTERIOR ELEVATIONS AND DECOR DRAWINGS BY OTHERS. WALL DECOR / PAINT TO EXTEND TO CEILING AND/OR BOTTOM OF ROOF DECK (WHERE EXPOSED TO STRUCTURE).
- PT-XXX PAINT PAINT OR RE-PAINT WALLS & SOFFITS. PAINT BACK & BOTTOM OF SOFFIT TO MATCH FRONT FACE OF SOFFIT. SEE DECOR DRAWINGS AND KROGER SPECIFICATIONS.
- CL-701 REPLACE EXISTING WAINSCOT WITH NEW ON WALLS VISIBLE TO CUSTOMERS AND WHERE INDICATED WITH NEW WAINSCOT (CL-701) WAINSCOT TO 3'-6" AFF, BUMPERS (BP-701) AND WALL BASE (WB-701). PROVIDE NEW WAINSCOT, BUMPERS AND WALL BASE AT NEW WALLS.
- E-PT PAINT EXISTING AND RELOCATED CASES PER ARTISAN DECOR. SEE FIXTURE/CASE NOTE F7.
- CL- NEW SCORED FRP IN PREP AREAS. THE NEW SCORED FRP IS TO BE INSTALLED OVER THE EXISTING WALL TILE. SEE DETAIL 711, THIS SHEET. SEE PROJECT SPECIFICATIONS AND DECOR DRAWINGS BY DFAB.
- CL-706 SCORED FRP TO BE INSTALLED IN DELI PREP
- CL-708 SCORED FRP TO BE INSTALLED IN SEAFOOD PREP
- CL-709 SCORED FRP TO BE INSTALLED IN DELI PREP / PREPARED FOODS
- CL-710 SCORED FRP TO BE INSTALLED IN BAKERY PREP

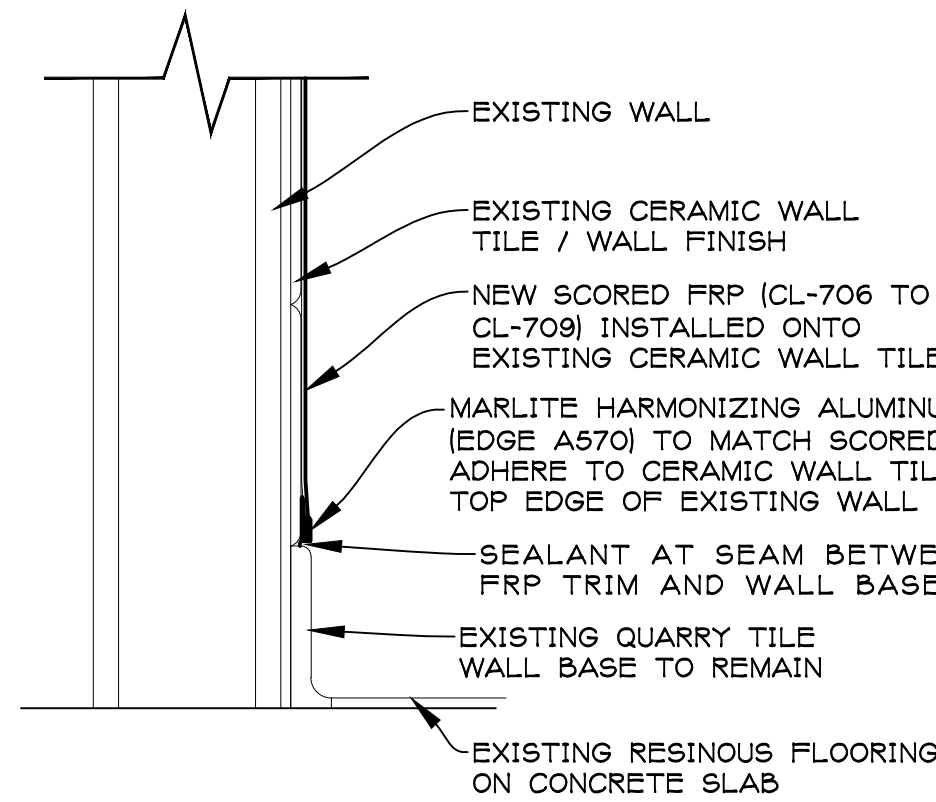

NOTE: KROGER TO PROFESSIONALLY CLEAN EXISTING TOILET ROOM WALL FINISHES.

FIXTURE / CASE NOTES:

- F1. G.C. TO PROVIDE & INSTALL ALL CUSTOM MILLWORK & SHADOWBOX (COORDINATE WITH KROGER PROJECT MANAGER). G.C. TO PROVIDE & INSTALL ALL CASE/SHELVING FILLERS & WEDGES SHOWN ON F1 (FIXTURE PLAN). SEE DETAIL 611 ON SHEET A6.1 FOR SIMILAR.
- F2. MILLWORK SUPPLIED BY KROGER & INSTALLED BY CONTRACTOR. COORDINATE WITH KROGER PROJECT MANAGER. MODIFIED MILLWORK TO MATCH EXISTING MILLWORK, UNO.
- F3. G.C. TO PROVIDE 4 CARPENTERS FOR 80 HOURS EACH TO ASSIST WITH THE RESET, GONDOLA MOVES AS REQUIRED FOR NEW LAYOUT AND FINISHES, MISC. FIXTURING ITEMS AND "BORE THUMBS". THIS TIME IS IN ADDITION TO THE TIME REQUIRED FOR THE INSTALLATION AND RELOCATION OF ALL FIXTURES SHOWN ON THESE DOCUMENTS. PROVIDE AN \$1000.00 ALLOWANCE FOR MISC. MATERIALS REQUIRED FOR THIS WORK.
- F4. INSTALL DROP CORD PER SPECS AND ELECTRICAL DRAWINGS. VERIFY QUANTITY & LOCATIONS WITH KROGER PROJECT MANAGER PRIOR TO INSTALLATION. FOR BERRY CASE & OTHER SMALL FIXTURES REQUIRING POWER, PROVIDE OUTLET ON COLUMN OR ELECTRICAL DROP PER ESD-16, LOCATION AS SELECTED BY KROGER PROJECT MANAGER.
- F5. G.C. TO RE-FINISH ALL SURFACES OF EXISTING MILLWORK, FILLERS, AND SHADOWBOXES TO REMAIN PER SPECIFICATIONS (SECTION 01 61 28 FIXTURE FINISH REFERENCE GUIDE). G.C. TO MAKE ALL NECESSARY REPAIRS TO PREP FOR NEW FINISH. SEE KROGER PROJECT MANAGER FOR ALL FINISHES.
- a. NOT USED.
- b. RE-FINISH THE EXISTING CUSTOMER SERVICE MILLWORK AND COUNTERTOPS.
- c. RE-FINISH THE EXISTING FLORAL MILLWORK (SOLID-SURFACE COUNTERTOPS TO REMAIN).
- d. RE-FINISH THE EXISTING PHARMACY AND COUNSEL ROOM MILLWORK AND COUNTERTOPS.
- e. RE-FINISH THE EXISTING 6' SERVICE CHICKEN CASE AT DELI FRONT LINE.
- F6. GONDOLA MOVERS PROVIDED BY KROGER.
- F7. G.C. TO ELECTROSTATICALLY PAINT EXTERIOR OF EXISTING & RELOCATED REFRIGERATED CASES 145 CHARCOAL GRAY. PAINT ALL ITEMS INDICATED ON PLAN INCLUDING ALL EXISTING/ RELOCATED CASES THAT ARE CURRENTLY PAINTED CHARCOAL BROWN OR OTHER. NEW CASES WILL BE ORDERED IN HUSSMAN 145 CHARCOAL GRAY. REMOVE ALL SIGNS, TRACK ECT FROM CASES PRIOR TO PAINTING. REPAIR/PATCH ALL HOLES IN CASES & OTHER DAMAGE PRIOR TO PAINTING. G.C. TO INSTALL ALL NEW KICK PLATES, BUMPERS, AND TRIM FOR CASES PROVIDED BY KROGER. CASE TOP VALANCES TO BE RE-PAINTED BLACK. MURRAY'S CHEESE CASES TO BE PAINTED RED. PROVIDE ELECTROSTATIC PAINT FOR ALL EXISTING & RELOCATED REFRIGERATED/FROZEN FOOD CASES PER SPECIFICATIONS SECTION 09 07 13 AND KROGER PROJECT MANAGER'S DIRECTION.
- F8. PROVIDE NEW REFRIGERATION CASE VALANCES ON ALL NEW AND RELOCATED REFRIGERATION CASES (AS INDICATED) TO ALIGN WITH & MATCH THE MATERIAL & DESIGN OF THE EXISTING VALANCES. TO BE PAINTED BLACK. SEE FINISH NOTE F7.

INTERIOR FINISH PLAN GENERAL NOTES: D-409

- A. COORDINATE ALL DECOR ITEMS WITH OTHERS.
- B. G.C. TO COORDINATE AND PROVIDE ALL NECESSARY SERVICES FOR TEMPORARY RELOCATION OF ALL FIXTURES THAT NEED TO BE MOVED DUE TO DEMOLITION AND CONSTRUCTION. THIS INCLUDES DISCONNECTING AND RECONNECTING ALL REQUIRED ELECTRICAL, MECHANICAL AND REFRIGERATION CONNECTIONS FOR EXISTING FIXTURES TO ALLOW FOR NEW WALL FINISHES.
- C. RETURN ALL WALL FINISHES TO STORE FRONT FRAME.
- D. SEE SPECIFICATIONS FOR DECOR INSTALLATION REQUIREMENTS.
- E. SEE REFLECTED CEILING PLAN, SHEET A1.3, FLOOR FINISH PLAN A1.6 INTERIOR ELEVATIONS A2.3.1 AND A2.3.2, ROOM FINISH SCHEDULE A6.1 AND DECOR SHEETS BY OTHERS FOR ADDITIONAL INFORMATION.
- F. PATCH AND REPAIR EXISTING WALLS AS REQUIRED DUE TO DEMOLITION AND CONSTRUCTION. REPAIR AND/OR REPLACE ALL CONSTRUCTION AND/OR FINISHES AS REQUIRED DUE TO DEMOLITION WORK. COORDINATE WITH ALL DEMOLITION PLANS (ARCHITECTURAL, MECHANICAL, PLUMBING AND ELECTRICAL).
- G. SEE PROJECT SPECIFICATIONS MANUAL FOR ADDITIONAL INFORMATION AND COMPLETE SCHEDULE.
- H. SEE SECTION 01 61 27 FOR THE KROGER "ARTISAN FIXTURE FINISH REFERENCE GUIDE" IN THE PROJECT SPECIFICATIONS MANUAL FOR FIXTURE FINISHES UNLESS OTHERWISE DIRECTED BY THE KROGER PROJECT MANAGER.
- I. G.C. TO COORDINATE REMOVAL OF EXISTING GRAPHICS/DECOR AND INSTALLATION OF ALL NEW DECOR ITEMS PROVIDED BY KROGER / DECOR, INCLUDING (BUT NOT LIMITED TO):
- AISLE MARKERS
 - CHECKLANES & U-SCANS
 - WINE, BEER, BEVERAGES
 - BEAUTY / PERSONAL CARE, BABY
 - VARIOUS DEPARTMENT GRAPHICS, WALL GRAPHICS & DECOR
 - CUSTOMER SERVICE / MONEY SERVICES (EXISTING MAY BE REUSED, VERIFY WITH KROGER PROJECT MANAGER)
 - NEW CASE AND GONDOLA SIGNS
- J. SEE DECOR DRAWINGS BY OTHERS FOR ALL HANGING HEIGHTS FOR SIGNAGE/DECOR ITEMS.

FINISH LEGEND:

D-409

DECOR SERIES #700 (ARTISAN DECOR)

SEE THE JSA CONSTRUCTION DRAWINGS AND PROJECT SPECIFICATIONS. SEE PROJECT SPECIFICATIONS SECTION 01 61 27 "DECOR INTERIOR FINISHES AND COLORS - ARTISAN" FOR INFORMATION ON THE FINISHES AND DECOR. COORDINATE EXTENT OF FINISH AND DECOR WORK WITH DECOR DRAWINGS BY OTHERS AND THE KROGER PROJECT MANAGER.

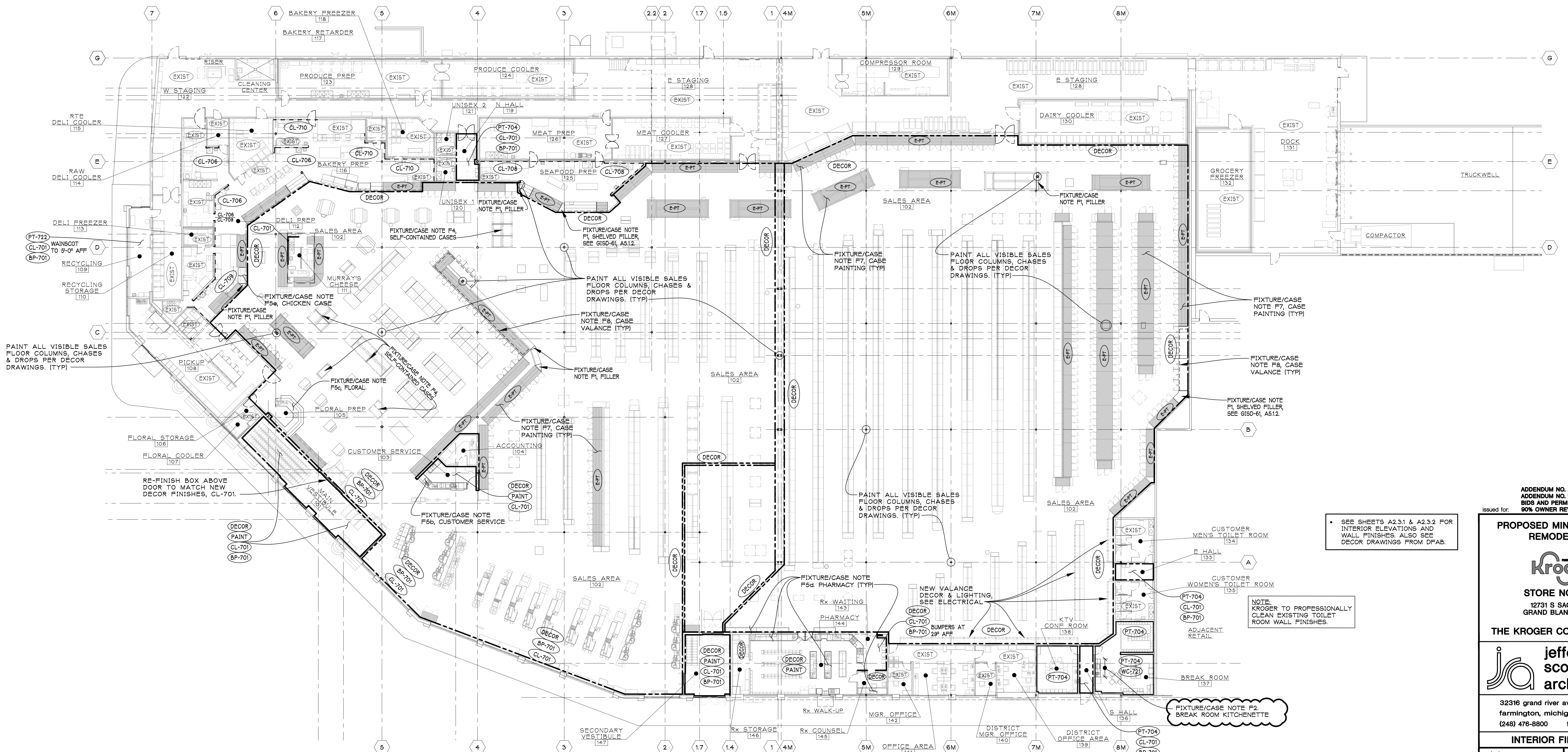

• SEE SHEETS A2.3.1 & A2.3.2 FOR INTERIOR ELEVATIONS AND WALL FINISHES. ALSO SEE DECOR DRAWINGS FROM DFAB.

NOTE: KROGER TO PROFESSIONALLY CLEAN EXISTING TOILET ROOM WALL FINISHES.

FIXTURE/CASE NOTE F2, BREAK ROOM KITCHENETTE

ADDENDUM NO. 2
ADDENDUM NO. 1
BIDS AND PERMITS
90% OWNER REVIEW

02/20/2024
02/16/2024
01/31/2024
10/23/2023

PROPOSED MINOR INTERIOR REMODEL FOR:



STORE NO. D-409
12731 S SAGINAW ST
GRAND BLANC, MI 48439

THE KROGER CO. OF MICHIGAN



32316 grand river ave. suite 200
farmington, michigan 48336-3261
(248) 476-8800 fax (248) 476-8833

INTERIOR FINISH PLAN

project no. 23042 sheet no. I1.4

INTERIOR FINISH PLAN
SCALE: 1/16" = 1'-0"

copyright © 2024